

## RESTAURANT. BALI

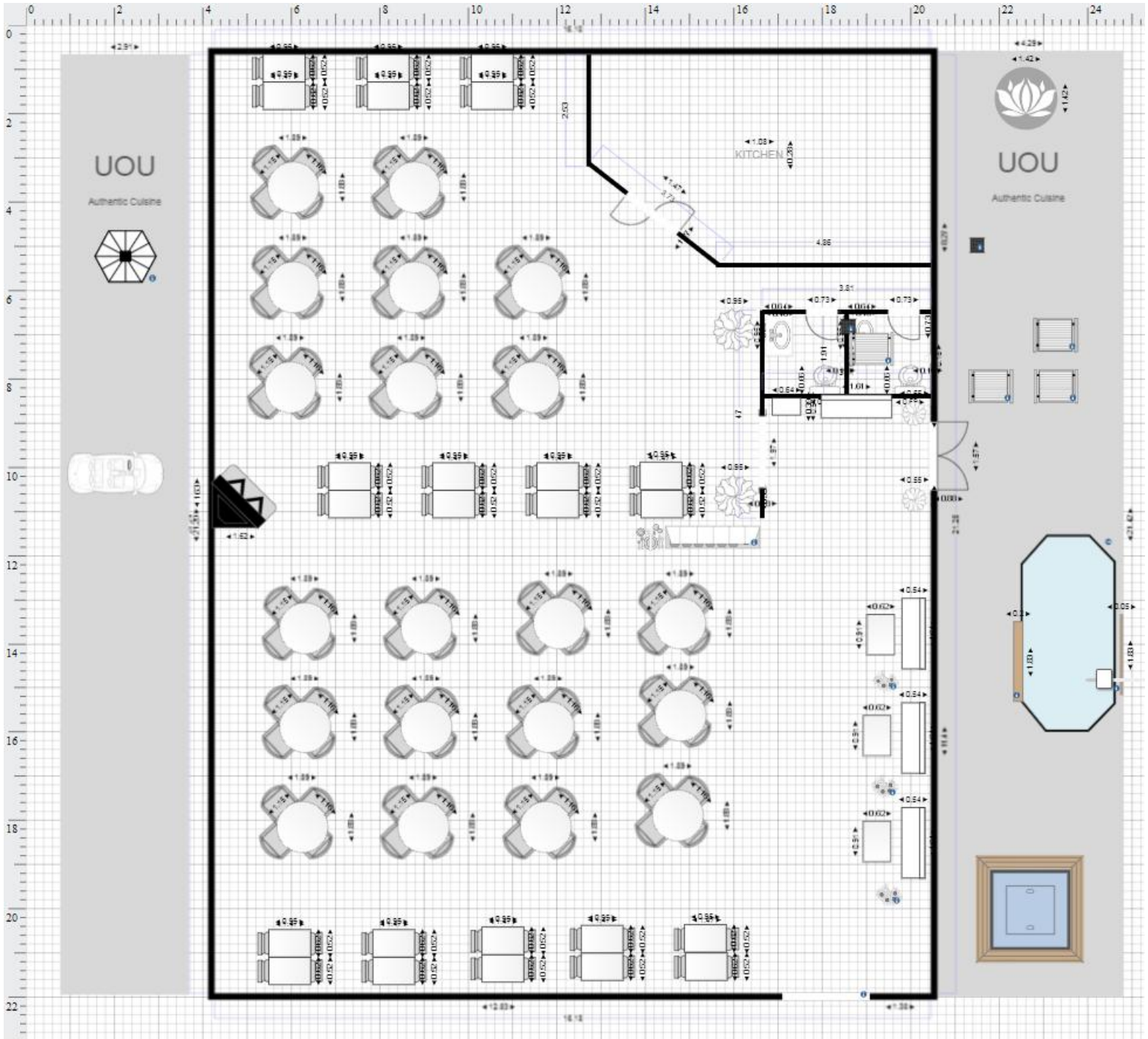



## Finance model restaurant

Description				
Location			Batur	
Usage			Kintamani	
Site, sq.m			Restaurant	600
Construction				
Site lease fee, yearly		K IDR	90 000	6 000 \$
	<i>Site lease fee 100 sq.m, yearly</i>	K IDR	15 000	1 000 \$
Design & art fee		K IDR	750 000	50 000 \$
Construction fee total		K IDR	6 000 000	400 000 \$
	<i>Construction fee per sq.m,</i>	K IDR	10 000	667 \$
	<i>Aim period, months</i>		18	
	<i>Construction risk</i>		200%	
<b>Total zero expences</b>		<b>K IDR</b>	<b>6 840 000</b>	<b>456 000 \$</b>
Rental				
	<i>Rent rate, yearly</i>	K IDR	525 000	35 000 \$
Business				
Tables			30	
	<i>Seats</i>		120	
	<i>Guests</i>		180	
Average bill		K IDR	150	10 \$
Outputs				
	<i>Revenue per day</i>	K IDR	27 000	1 800 \$
	<i>Revenue per month</i>	K IDR	810 000	54 000 \$
	<i>Margin rate only Rest.</i>		20%	
	<i>Margin volume only Rest.</i>	K IDR	1 854 000	123 600 \$
	<i>Margin rate w/o Rent</i>		34%	
<b>Margin volume w/o Rent, yearly</b>		<b>K IDR</b>	<b>3 273 000</b>	<b>218 200 \$</b>
ROI				
<b>Return of Investment, years</b>			<b>2.06</b>	
<b>Return of Investment w. Cons.Risk, years</b>			<b>4.12</b>	